

Excavation/Footing Observation

CLIENT: Hennepin
141526 W. 90th Drive (140.00)
 FIELD REPRESENTATIVE: Chris Williams
 DATE OF OBSERVATION: 10/31/2023 TIME: 3pm
 WEATHER CONDITIONS: Clear 44°

PROJECT NO: DN49791900F-305
 SUBDIVISION: Whisper Village FILING: _____
 ADDRESS: 141526 W. 90th Drive
 LOT: 3 BLOCK: Unit C

Recommended Foundation System

SOILS REPORT BY: CTL
 PROJECT NO: DN49791-126-R1
 DATED: 07/21/2022

- SPREAD FOOTINGS
 MAXIMUM SOIL PRESSURE OF _____ PSF.
 MINIMUM WIDTH _____ INCHES
- FOOTINGS WITH MINIMUM DEADLOAD
 MAXIMUM SOIL PRESSURE OF 5000 PSF.
 MINIMUM DEADLOAD PRESSURE OF 1000 PSF.
 PROVIDE A 4 INCH VOID BENEATH GRADE BEAMS
 MINIMUM WIDTH 16 18x18 pad INCHES

Foundation Plan

BY: CTL
 PLAN NO: SA-004 DATED: 07/19/2023
 WALL FOOTING WIDTH PER PLAN YES NO
 COLUMN PAD PER PLAN YES NO
 REINFORCEMENT AS PER PLAN:
 YES NO NONE REQUIRED
 AT SITE INSTALLED

Soil Conditions At Footing Level

UPPER LEVEL: Fill Clay Brown Sandy
 LOWER LEVEL: Fill Clay Brown Sandy

Ground Water Conditions

NONE IN EXCAVATION
 NONE ENCOUNTERED IN BORING NO. TH-1 TO 20 FEET
 ENCOUNTERED AT _____ FEET IN BORING NO. _____

Remarks _____

Foundation Layout

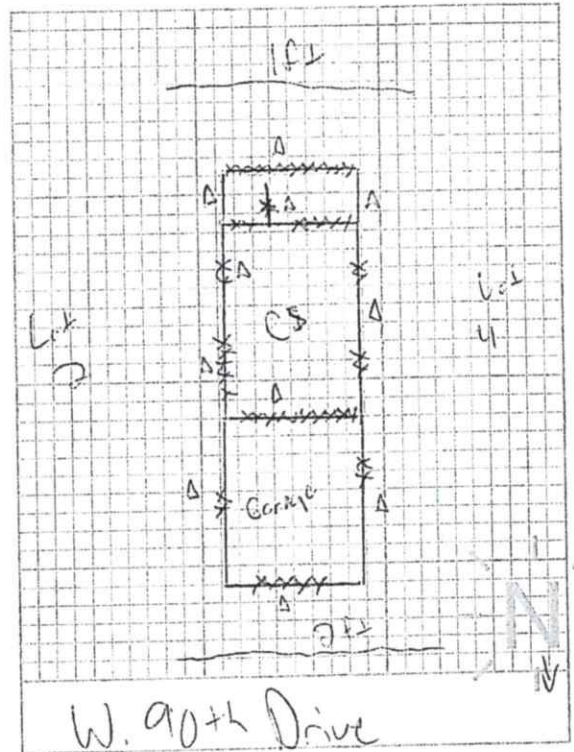

▲ INDICATES APPROXIMATE DEPTH/WIDTH MEASUREMENT LOCATION

Summary Of Observations

- FOOTING IN GENERAL CONFORMANCE WITH PLAN
 FOOTING REJECTED; ADDITIONAL OBSERVATION REQUIRED
 CONDITIONS IN EXCAVATION AS ANTICIPATED
 CONDITIONS IN EXCAVATION NOT AS ANTICIPATED, CONTACT GEOTECHNICAL ENGINEER; ADDITIONAL OBSERVATION REQUIRED



REVIEWED BY _____