

CITY OF ARVADA
 ANY CHANGE OR DEVIATION FROM THESE PLANS MUST BE APPROVED BY ARVADA BUILDING DEPARTMENT

THIS SET OF PLANS TO STAY ON JOB AT ALL TIMES REVIEWED FOR CODE COMPLIANCE 2018 International Codes (as amended) 2023 NEC (as amended)

APPROVED SUBJECT TO FIELD INSPECTION

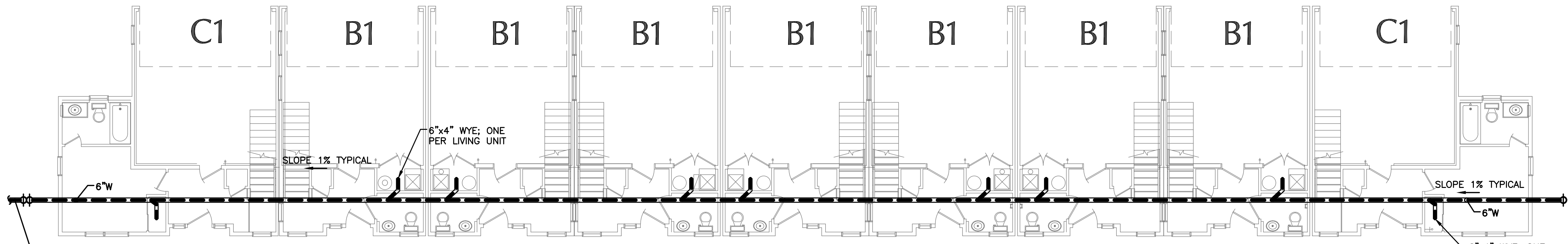

4 SANITARY SEWER 1st FLOOR PLAN Bldg-6 (9 Total Units)
 SS2.10 SCALE: 1/8" = 1'-0"

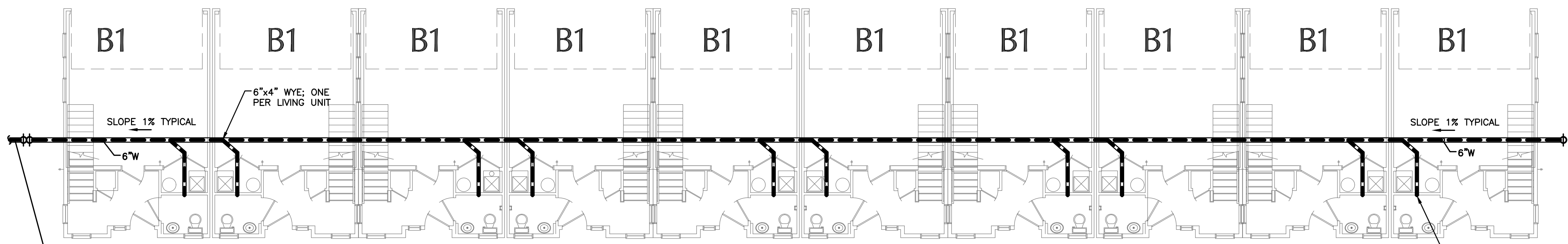

3 SANITARY SEWER 1st FLOOR PLAN Bldg-3 (Bldg 4 and 5 similar) (10 Total Units)
 SS2.10 SCALE: 1/8" = 1'-0"

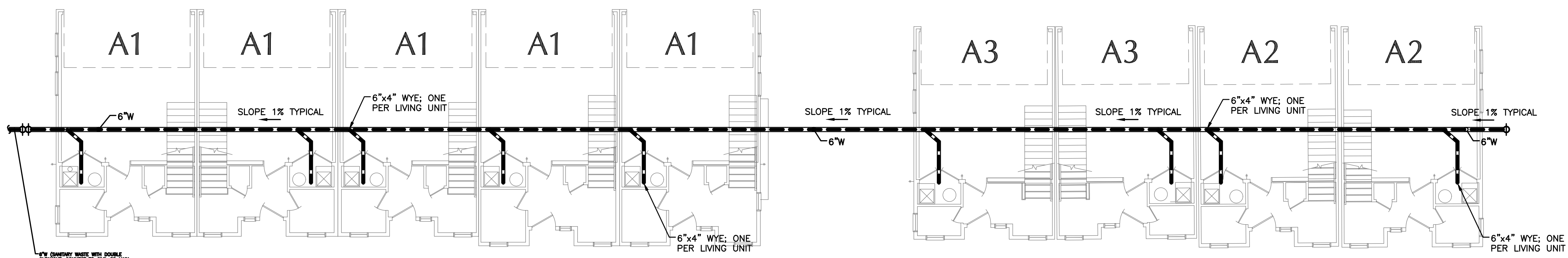

1 SANITARY SEWER 1st FLOOR PLAN Bldg-1 (5 Total Units)
 SS2.10 SCALE: 1/8" = 1'-0"

2 SANITARY SEWER 1st FLOOR PLAN Bldg-2 (4 Total Units)
 SS2.10 SCALE: 1/8" = 1'-0"

| PLUMBING LEGEND | | | |
|-----------------------|---|------|-------------------|
| (E) EXISTING | ⊕ | COTG | CLEANOUT TO GRADE |
| (R) REMOVE | ⊖ | FCO | FLOOR CLEANOUT |
| (R) REMOVE & RELOCATE | ⊕ | WCO | WALL CLEANOUT |
| GPM | ⊕ | ES | FLOOR SINK |
| MBH | ⊕ | ED | FLOOR DRAIN |
| AFF | ⊕ | AD | AREA DRAIN |
| VTR | ⊕ | ED | PLANTER DRAIN |
| ⊕ | ⊕ | GD | GARAGE DRAIN |
| ⊕ | ⊕ | | CONNECTION POINT |

| SYMBOL | ABBREY. | DESCRIPTION |
|--------|---------|-----------------------|
| —W— | W | SANITARY WASTE BURIED |
| —W— | W | SAN WASTE ABOVE GRADE |
| —V— | V | SANITARY VENT |

- SANITARY SEWER PIPING SPECIFICATIONS - Div23**
- PLUMBING SPECIFIC**
- SANITARY SEWER piping: Schedule-40 PVC buried shall be solid-wall PVC Schedule-40 dual cement ASTM-D2665; above grade may be cell-core ASTM-1785. Provide cleanouts 100ft min OC of appropriate type inside buildings and at the base of each stack with listed flex bellows.
- GENERAL:**
- LOCAL and STATE CODES/ORDINANCES and CONDITIONS of CONTRACT shall be followed. SUBMIT plans to Building Department for Plan Review. Follow correction requirements. Pay all Fees and attain all Permits.
 - ADOPTED ENERGY CODE shall be followed. All equipment, insulation, and controls shall conform.
 - VISIT SITE daily to ascertain existing conditions prior to ordering equipment or fabricating duct and piping.
 - GAS DRAWINGS are schematic and not to be scaled. Refer to Architectural/Certified drawings and site measurements for dimensions.
 - AS-BUILT scale drawings shall be provided by Contractor and submitted to Div23 Engineer at completion showing all piping and equipment changes.
 - EQUIPMENT SHOWN ON DRAWINGS and SPECIFICATIONS: Contractor shall order, purchase, receive, uncrate, assemble, and install all items in conformance to Manufacturer's recommendations. Additionally Contractor shall install and final connect Owner furnished items as indicated on drawings.
 - BASE BID on specified equipment as shown on plans and in specifications.
 - SUBSTITUTIONS will be processed as change-orders after Bidding with all electrical, building alterations, and dollar amounts are included and approved in writing by Div23 engineer and owner prior to ordering equipment or fabrication.
 - EXTRA COSTS or CHANGES allowed only if approved in writing by Engineer with dollar amount prior to ordering.
 - SUPPORTS and ANCHORS shall be provided for GAS PIPING work. No chain, tape, wire.
 - SLEEVES and COLLARS shall be provided for all pipes thru walls, floors, and ceilings. Provide chrome plated escutcheons for exposed piping penetrations thru ceilings, floors, and walls in finished areas.
 - CONCEAL all work in finished areas.
 - CUT and PATCH to match adjacent areas. No structural member shall be cut or notched.
 - ONLY CONTRACTORS WITH EXPERIENCE on at least 3 projects of this type may bid.
 - RFI (Request For Information) from Contractor shall include at least one proposed solution which complies with the intent of Contract Documents.
 - MOCK-UP CLAUSE: for each unit type, Contractor shall substantially complete the installation of all HVAC equipment, ductwork, grilles, flues, combustion air, etc, for full coordination with all other trades. Attain approval from Architect, Engineer, Building Department and owner prior to installations of similar units of the same type.
 - GUARANTEE all labor and new equipment for one year from the date of acceptance by Owner.

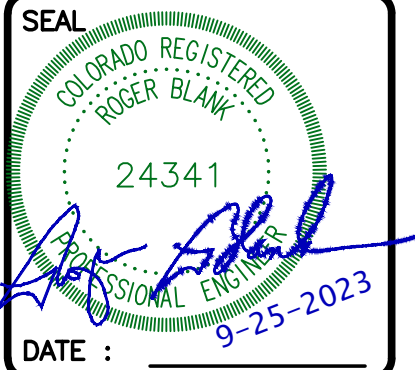

5280 Engineering
 www.DesignMEP.com
 720-320-7744

RALSTON COURT
 8705 Ralston Road, Arvada, CO 80002

DRAWN: RWB
 CHECKED: RSB

| SHEET TITLE : | |
|---|--------|
| BUILDING SANITARY SEWER PLANS | |
| BUILDING SANITARY SEWER PLANS | |
| (1st FLOOR LEVEL): BUILDINGS 1, 1.2, 3, 4, 5, 6 | |
| REVISION | RECORD |
| No. | DATE |
| | |
| | |
| | |

BUILDING CODES: (Arvada, CO)
 2018 IRC

SANITARY SEWER PLAN INDEX:

SS2.10 BUILDING SANITARY SEWER PLANS: 1st LEVEL OF EACH OF 4 BUILDING TYPES

DATE : 9-25-2023
 SHEET NUMBER:

SS2.10

PROJECT #: 23-034