

Plan

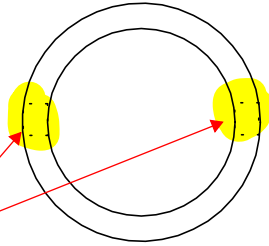

2 Standard Knock-outs

Elevation

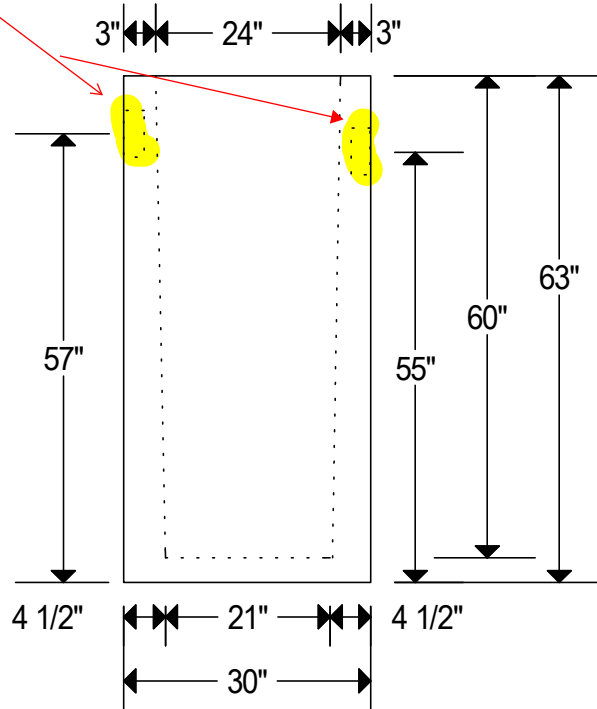

Notes:

Reinforced With 6 x 6 10/10 Wire Mesh.

Weight: Monolithic Bottom 1,700 lbs.

Lifting Plan: Use 3/4" Flared Ferrule Inserts (C1324516CW)

Comes Standard With Two 6" x 6" Blockouts.

5,000 P.S.I. Minimum Strength Concrete.

We Produce A Green And Environmentally Friendly Product.



24" One Piece Sump Pit

No Scale

Page 13